

Application for a premises licence to be granted under the Licensing Act 2003**PLEASE READ THE FOLLOWING INSTRUCTIONS FIRST**

Before completing this form please read the guidance notes at the end of the form. If you are completing this form by hand please write legibly in block capitals. In all cases ensure that your answers are inside the boxes and written in black ink. Use additional sheets if necessary. You may wish to keep a copy of the completed form for your records.

I/We Bournemouth Holding Co Ltd

(Insert name(s) of applicant)

apply for a premises licence under section 17 of the Licensing Act 2003 for the premises described in Part 1 below (the premises) and I/we are making this application to you as the relevant licensing authority in accordance with section 12 of the Licensing Act 2003

Part 1 – Premises details

Postal address of premises or, if none, ordnance survey map reference or description Lazyjacks Bar and Restaurant Boatyard Café 30 – 32 Panorama Road			
Post town	Poole	Postcode	BH13 7RD

Telephone number at premises (if any)	01202 133833
Non-domestic rateable value of premises	£22,000

Part 2 - Applicant details

Please state whether you are applying for a premises licence as **Please tick as appropriate**

- | | | |
|-------------------------------------------------------------------------------------------------------------------------------------------------------------------------|-------------------------------------|-----------------------------|
| a) an individual or individuals * | <input type="checkbox"/> | please complete section (A) |
| b) a person other than an individual * | | |
| i as a limited company/limited liability partnership | <input checked="" type="checkbox"/> | please complete section (B) |
| ii as a partnership (other than limited liability) | <input type="checkbox"/> | please complete section (B) |
| iii as an unincorporated association or | <input type="checkbox"/> | please complete section (B) |
| iv other (for example a statutory corporation) | <input type="checkbox"/> | please complete section (B) |
| c) a recognised club | <input type="checkbox"/> | please complete section (B) |
| d) a charity | <input type="checkbox"/> | please complete section (B) |
| e) the proprietor of an educational establishment | <input type="checkbox"/> | please complete section (B) |
| f) a health service body | <input type="checkbox"/> | please complete section (B) |
| g) a person who is registered under Part 2 of the Care Standards Act 2000 (c14) in respect of an independent hospital in Wales | <input type="checkbox"/> | please complete section (B) |
| ga) a person who is registered under Chapter 2 of Part 1 of the Health and Social Care Act 2008 (within the meaning of that Part) in an independent hospital in England | <input type="checkbox"/> | please complete section (B) |
| h) the chief officer of police of a police force in England and Wales | <input type="checkbox"/> | please complete section (B) |

* If you are applying as a person described in (a) or (b) please confirm (by ticking yes to one box below):

I am carrying on or proposing to carry on a business which involves the use of the premises for licensable activities; or ☒

I am making the application pursuant to a statutory function or ☐

a function discharged by virtue of Her Majesty's prerogative ☐

(B) OTHER APPLICANTS

Please provide name and registered address of applicant in full. Where appropriate please give any registered number. In the case of a partnership or other joint venture (other than a body corporate), please give the name and address of each party concerned.

Name Bournemouth Holding Co Ltd
Address 1a Kingsbury Lane Ringwood BH24 1EL
Registered number (where applicable) 15418234
Description of applicant (for example, partnership, company, unincorporated association etc.) Private Limited Company
Telephone number (if any) [REDACTED]
E-mail address (optional) [REDACTED]

Part 3 Operating Schedule

When do you want the premises licence to start?

DD	MM	YYYY
<input type="text"/>	<input type="text"/>	<input type="text"/>

AS SOON AS POSSIBLE

If you wish the licence to be valid only for a limited period, when do you want it to end?

DD	MM	YYYY
<input type="text"/>	<input type="text"/>	<input type="text"/>

Please give a general description of the premises (please read guidance note 1)
The premises have the benefit of a Premises Licence number BH182896 which includes a lounge area at the rear. That area is no longer used as part of the licensed premises and is now a yacht chandlery.
However, the first floor above that part of the current premises that is used as a bar/café/restaurant has hitherto been used only for storage but is about the same size as the previous lounge area. The intention is to incorporate that upstairs area within the licenced area but to exclude the former lounge.
The premises will continue to operate as at present and the current licence will be surrendered before any new licence comes into effect. Note that the application includes more comprehensive conditions than those on the existing licence but that the hours sought are the same as on the existing licence.

If 5,000 or more people are expected to attend the premises at any one time, please state the number expected to attend.

Not applicable

What licensable activities do you intend to carry on from the premises?
(please see sections 1 and 14 and Schedules 1 and 2 to the Licensing Act 2003)

Provision of regulated entertainment (please read guidance note 2)

Please tick all that apply

- a) plays (if ticking yes, fill in box A) ☐
- b) films (if ticking yes, fill in box B) ☐
- c) indoor sporting events (if ticking yes, fill in box C) ☐
- d) boxing or wrestling entertainment (if ticking yes, fill in box D) ☐
- e) live music (if ticking yes, fill in box E) ☐
- f) recorded music (if ticking yes, fill in box F) ☐
- g) performances of dance (if ticking yes, fill in box G) ☐
- h) anything of a similar description to that falling within (e), (f) or (g) (if ticking yes, fill in box H) ☐

Provision of late night refreshment (if ticking yes, fill in box I) ☐

Supply of alcohol (if ticking yes, fill in box J) ☒

In all cases complete boxes K, L and M

J

Supply of alcohol Standard days and timings (please read guidance note 7)			Will the supply of alcohol be for consumption – please tick (please read guidance note 8)	On the premises	<input type="checkbox"/>
				Off the premises	<input type="checkbox"/>
				Both	<input checked="" type="checkbox"/>
Day	Start	Finish	State any seasonal variations for the supply of alcohol (please read guidance note 5) None.		
Mon	07:00	23:00			
Tue	07:00	23:00			
Wed	07:00	23:00			
Thur	07:00	23:00			
Fri	07:00	23:00			
Sat	07:00	23:00			
Sun	07:00	23:00	Non standard timings. Where you intend to use the premises for the supply of alcohol at different times to those listed in the column on the left, please list (please read guidance note 6) From 07:00 on New Year's Eve until 02:00 on 1 st January.		

State the name and details of the individual whom you wish to specify on the licence as designated premises supervisor (Please see declaration about the entitlement to work in the checklist at the end of the form):

Name [REDACTED]	
Date of birth [REDACTED]	
Address [REDACTED] [REDACTED] [REDACTED]	
Postcode	[REDACTED]
Personal licence number (if known) [REDACTED]	
Issuing licensing authority (if known) [REDACTED]	

K

Please highlight any adult entertainment or services, activities, other entertainment or matters ancillary to the use of the premises that may give rise to concern in respect of children (please read guidance note 9).

No adult entertainment, services activities etc will be provided.

L

Hours premises are open to the public Standard days and timings (please read guidance note 7)			State any seasonal variations (please read guidance note 5) None.
Day	Start	Finish	Non standard timings. Where you intend the premises to be open to the public at different times from those listed in the column on the left, please list (please read guidance note 6) From 07:00 on New Year's Eve until 02:00 on 1 st January.
Mon	07:00	23:00	
Tue	07:00	23:00	
Wed	07:00	23:00	
Thur	07:00	23:00	
Fri	07:00	23:00	
Sat	07:00	23:00	
Sun	07:00	23:00	

M

Describe the steps you intend to take to promote the four licensing objectives:

a) General – all four licensing objectives (b, c, d and e) (please read guidance note 10)

The relevant mandatory conditions shall apply to the licence.

This licence will have no effect unless and until Premises Licence BH182896 is surrendered.

b) The prevention of crime and disorder

The premises shall install and thereafter maintain in good working order a digital CCTV system covering all public parts of the premises internally and externally (except for the lavatories). Recordings shall be maintained for 31 days, facilities will be made available for the Police and other authorised officers to view recordings on request and be provided with copies in a playable format as soon as reasonably practical, provided that all such requests comply with data protection legislation.

The premises shall maintain an Incident Book to record:

Any instance of crime and/or disorder occurring at or immediately outside the premises;

Any ejection of a customer from the premises and the reason for the same;

Any refusal to supply alcohol to any person and the reason for the refusal.

In each case, the name of the member(s) of staff dealing with the incident shall be noted.

The Incident Book shall be checked no less frequently than monthly by the DPS who shall sign to that effect and be made available for inspection by Police and other authorised officers on request.

A waiter/waitress service shall be available at all times.

Non-alcoholic beverages including tea and coffee shall also be available at all times.

c) Public safety

Note for information that the applicant does not consider it appropriate to propose any condition under this licensing objective, in part because other legislation (such as the Regulatory Reform (Fire Safety) Order 2005) has effect.

d) The prevention of public nuisance

Note for information that the applicant does not consider it appropriate to propose any condition under this licensing objective, in part because any music entertainment would be provided under the Live Music Act.

e) The protection of children from harm

The premises shall adopt a "Challenge 25" policy whereby any person who appears to be under 25 years of age will be required to produce photographic proof of age in one or other of the forms specified by the mandatory conditions before being served alcohol.

All staff involved in the supply of alcohol who do not themselves hold a Personal Licence shall be trained regarding restricted supplies of alcohol to persons who are underage and/or intoxicated and on the terms and conditions of this licence.

Refresher training shall be provided at least annually.

A written record of all training shall be maintained and be made available for inspection by police and other authorised officers on request.

Checklist:**Please tick to indicate agreement**

- I have made or enclosed payment of the fee. ☒
- I have enclosed the plan of the premises. ☒
- I have sent copies of this application and the plan to responsible authorities and others where applicable. ☒
- I have enclosed the consent form completed by the individual I wish to be designated premises supervisor, if applicable. ☒
- I understand that I must now advertise my application. ☒
- I understand that if I do not comply with the above requirements my application will be rejected. ☒
- [Applicable to all individual applicants, including those in a partnership which is not a limited liability partnership, but not companies or limited liability partnerships] I have included documents demonstrating my entitlement to work in the United Kingdom or my share code issued by the Home Office online right to work checking service (please read note 15). ☐

IT IS AN OFFENCE, UNDER SECTION 158 OF THE LICENSING ACT 2003, TO MAKE A FALSE STATEMENT IN OR IN CONNECTION WITH THIS APPLICATION. THOSE WHO MAKE A FALSE STATEMENT MAY BE LIABLE ON SUMMARY CONVICTION TO A FINE OF ANY AMOUNT.

IT IS AN OFFENCE UNDER SECTION 24B OF THE IMMIGRATION ACT 1971 FOR A PERSON TO WORK WHEN THEY KNOW, OR HAVE REASONABLE CAUSE TO BELIEVE, THAT THEY ARE DISQUALIFIED FROM DOING SO BY REASON OF THEIR IMMIGRATION STATUS. THOSE WHO EMPLOY AN ADULT WITHOUT LEAVE OR WHO IS SUBJECT TO CONDITIONS AS TO EMPLOYMENT WILL BE LIABLE TO A CIVIL PENALTY UNDER SECTION 15 OF THE IMMIGRATION, ASYLUM AND NATIONALITY ACT 2006 AND PURSUANT TO SECTION 21 OF THE SAME ACT, WILL BE COMMITTING AN OFFENCE WHERE THEY DO SO IN THE KNOWLEDGE, OR WITH REASONABLE CAUSE TO BELIEVE, THAT THE EMPLOYEE IS DISQUALIFIED.

Part 4 – Signatures (please read guidance note 11)

Signature of applicant or applicant's solicitor or other duly authorised agent (see guidance note 12). **If signing on behalf of the applicant, please state in what capacity.**

Declaration	<ul style="list-style-type: none">• [Applicable to individual applicants only, including those in a partnership which is not a limited liability partnership] I understand I am not entitled to be issued with a licence if I do not have the entitlement to live and work in the UK (or if I am subject to a condition preventing me from doing work relating to the carrying on of a licensable activity) and that my licence will become invalid if I cease to be entitled to live and work in the UK (please read guidance note 15).• The DPS named in this application form is entitled to work in the UK (and is not subject to conditions preventing him or her from doing work relating to a licensable activity) and I have seen a copy of his or her proof of entitlement to work, or have conducted an online right to work check using the Home Office online right to work checking service which confirmed their right to work (please see note 15)
Signature	Philip J Day, Solicitor for Laceys Solicitors LLP

Date	9 th December 2025
Capacity	Solicitors for the Applicant





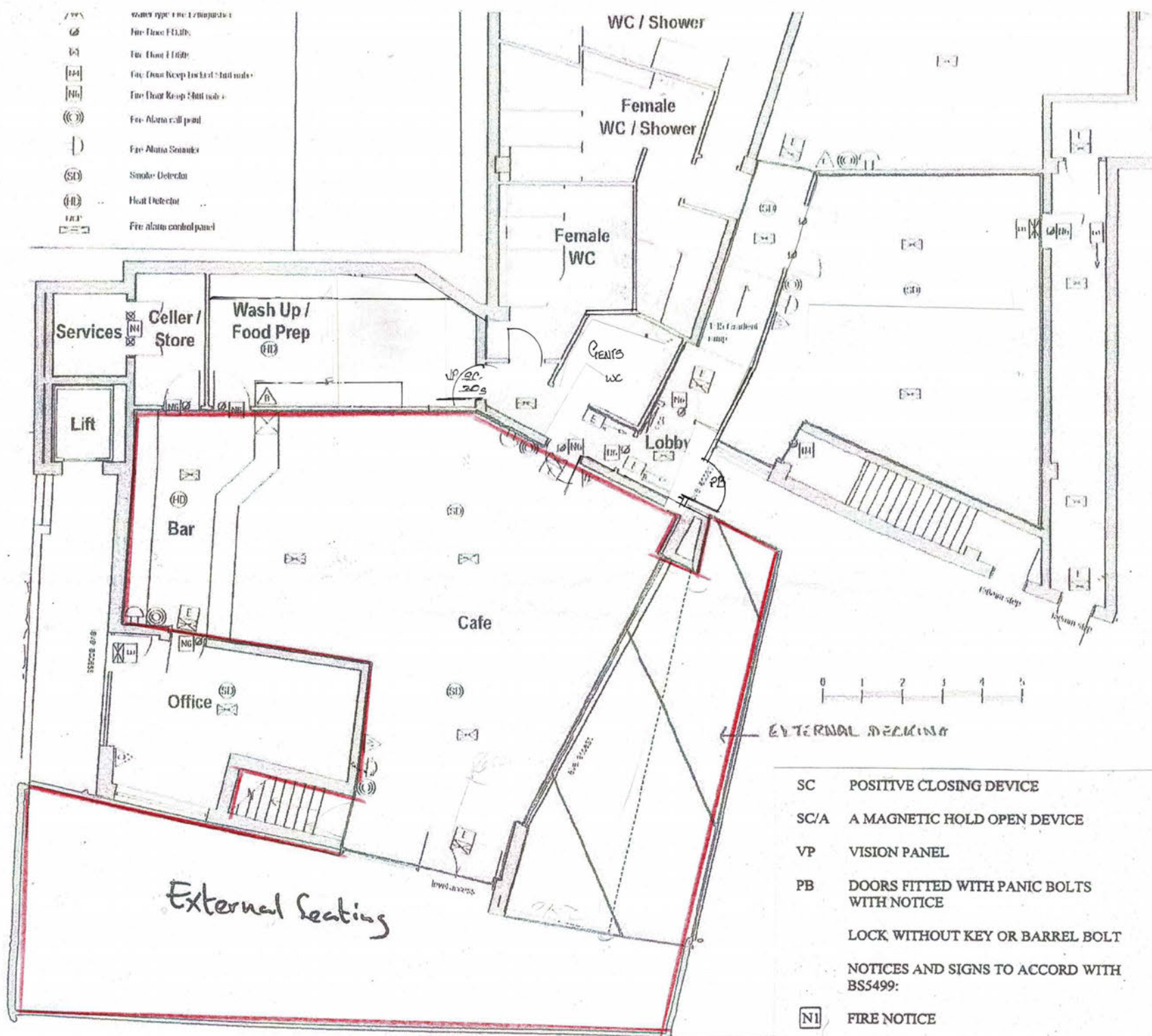

Contact name (where not previously given) and postal address for correspondence associated with this application (please read guidance note 14) Philip Day Laceys Solicitors LLP 9 Poole Road			
Post town	Bournemouth	Postcode	BH2 5QR
Telephone number (if any)	01202 377867		
If you would prefer us to correspond with you by e-mail, your e-mail address (optional) p.day@laceyssolicitors.co.uk			

Notes for Guidance

The Notes do not form part of the application form and have not been reproduced in the interest of sustainability.



LAZY JACKS POOLE	
Dwg title	
LICENSING PLANS	
Scale	
Dwg No 1/147/25 Date NOVEMBER 2025	

- SC POSITIVE CLOSING DEVICE
- SC/A A MAGNETIC HOLD OPEN DEVICE
- VP VISION PANEL
- PB DOORS FITTED WITH PANIC BOLTS WITH NOTICE
- LOCK WITHOUT KEY OR BARREL BOLT
- NOTICES AND SIGNS TO ACCORD WITH BS5499:
- N1 FIRE NOTICE
- N6 FIRE DOOR KEEP SHUT
- N9 TO BE UNLOCKED WHEN PREMISES ARE OCCUPIED
- E  INTERNALLY ILLUMINATED EXIT PICTOGRAM (ARROW INDICATES DIRECTION OF ESCAPE) (M = MAINTANED)
-  AREA COVERED BY EMERGENCY LIGHTING
-  FIRE ALARM CALL POINT
-  AUDIBLE WARNING DEVICE
-  AREA COVERED BY HEAT DETECTOR
-  AREA COVERED BY SMOKE DETECTOR (= OPTICAL)
-  FIRE EXTINGUISHER: WATER

- SC

POSITIVE CLOSING DEVICE
- SC/A

A MAGNETIC HOLD OPEN DEVICE
- VP

VISION PANEL
- PB

DOORS FITTED WITH PANIC BOLTS WITH NOTICE
- LOCK WITHOUT KEY OR BARREL BOLT
- NOTICES AND SIGNS TO ACCORD WITH BS5499:
- N1

FIRE NOTICE
- N6

FIRE DOOR KEEP SHUT
- N9

TO BE UNLOCKED WHEN PREMISES ARE OCCUPIED
- INTERNALLY ILLUMINATED EXIT PICTOGRAM (ARROW INDICATES DIRECTION OF ESCAPE) (M = MAINTAINED)

AREA COVERED BY EMERGENCY LIGHTING

FIRE ALARM CALL POINT

AUDIBLE WARNING DEVICE

AREA COVERED BY HEAT DETECTOR

AREA COVERED BY SMOKE DETECTOR (= OPTICAL)

FIRE EXTINGUISHER: WATER
- The diagram is a floor plan of a building with several rooms and safety features. The rooms are labeled: 'Office' (top left), 'Store' (middle left), 'Toilets' (middle left), 'Store' (middle right), 'Lounge' (bottom right), and 'Kitchen' (bottom right). The plan includes various safety symbols: fire notices (N1), fire door keep shut (N6), fire alarm call points (C), audible warning devices (A), heat detectors (H), smoke detectors (S), and fire extinguishers (E). A red line indicates a fire escape route. The plan also shows a fire alarm control panel (FACP) and a fire alarm call point (C).
- | |
|--------------------------------------------------------------------------------------------------------------------|
| SEAGER DESIGN
MOORTOWN HOUSE
CHRISTCHURCH ROAD
RINGWOOD
BH24 3AN 01425 483513
lynseager@outlook.com |
| LAZY JACKS
POOLE |
| |
| Dwg title
LICENSING PLANS |
| Scale |
| Dwg No
1/147/25
Date NOVEMBER 2025 |